

WARRANTY

Quality Warranty

Thank you for purchasing Aladdin's FLEXIBLE LED LIGHT. This product is produced by strict quality control and testing. You can receive below A/S(after service) due to problems using the product.

Warranty Coverage

If product failure is detected while normal use of the product during the guarantee period of quality, we will repair or exchange the product free of charge
- guarantee period of quality : 1 year

Exclusions and Limitation of Liability

Aladdin reserves the rights to refuse warranty service of products under disputable conditions. Aladdin also holds the rights to declare final decision whether products are within warranty. The following actions and damages will result in voiding the limited warranty:

- Product failure after the guarantee period of quality.
- Product failure due to consumer's negligence.
- Product failure due to power trouble or faulty adapter.
- Product failure due to natural disaster.

SPECIFICATIONS (600X300)

Model	Symbol	AMS FL100
Light source		High CRI LED
power consumption	W	100
Beam Angle	°	130
Color temperature	K	2900 ~ 6000
Color Rendering Index	Ra	Typ 97
Input Voltage	AC	100 ~ 240V / 50,60Hz
Dimming	%	0~100
Size	mm	600X300
LED module Weight	g	400

Purchased store :

Purchased date :

Manufacturer / Supplier : Aladdin / www.aladdin-lights.com / TEL : 82-2-386-1245

3, World cup buk-ro 42 na-gil, mapo-gu, Seoul, 03930, Rep of Kore

Bi-Flex Lite

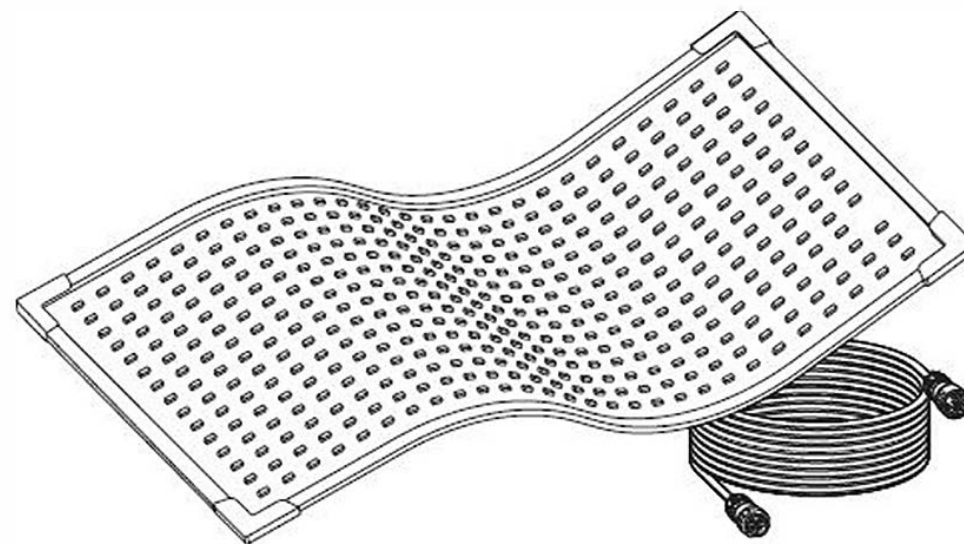

MODEL : AMS-FL100BI

Product Manual for flexible LED light

- ◆ Bi Color LED satisfies all the condition of Broadcast, Movie, Picture
- ◆ High color rendering index over 97Ra
- ◆ Wide range color Temperature(2900 ~ 6000K)
- ◆ Portable structure using rechargeable Li-Ion battery (option)
- ◆ UV 90% cut off

Aladdin

CAUTION

This product is portable lighting equipment using FLEXIBLE LED.

The product satisfies condition of Broadcast / Movie / Picture that maximized high quality / lightweight / portable. Read the instruction before you use the product.

When you have a problem with the product stop using the product immediately and contact the store or the A/S center.

IMPORTANT CAUTIONS AND WARNINGS

- Do not use near Flammable's and heater.
- Do not use long hours in rain or places that the product may get wet.
- Do not expose to direct sunlight, We advise that you do not store or use it in a vehicle.
- The product will heat up when you use the product for a long period of time. In this case move the product with a X type cradle or handle.
- Cool the LED before you store the product.
- Use the product only in the temperature range of -10°C ~ 40°C.
- Use private article for power and control system If you use other product their may be problem.
- Do not use the light attached wire as a hanger or movable handle.
- Do not bend or fold the light more than 90degrees.
- Spread the light for storage.
- Keep out of infants.
- Do not touch with wet hands. (Risk of electric shock)
- Separate the power and controller before storage.
- Do not push the product with improper force or give impact with heavy object.
- Carefully fold the light source module

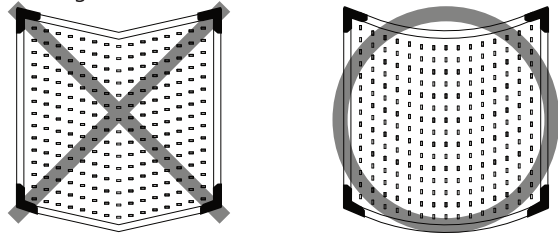

- Do not put the adhesive Tape in front of a light source module

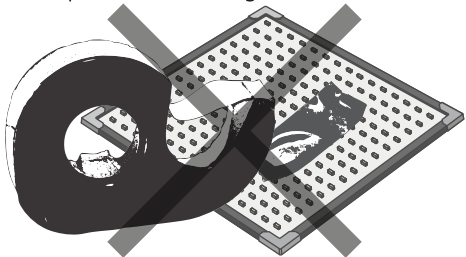

METHOD

Connecting guide

- As the following picture, connect the structure by ① Power Adaptor → ② Controller → ③ LED light source
 - If the distance between the lamp and the controller module, Use to connect a DC cable
 - If using an exterior battery, connect the battery instead of the adaptor.
- ※ Always connect the product as the above order because if you directly connect the adaptor to the light source the over current may damage the product.

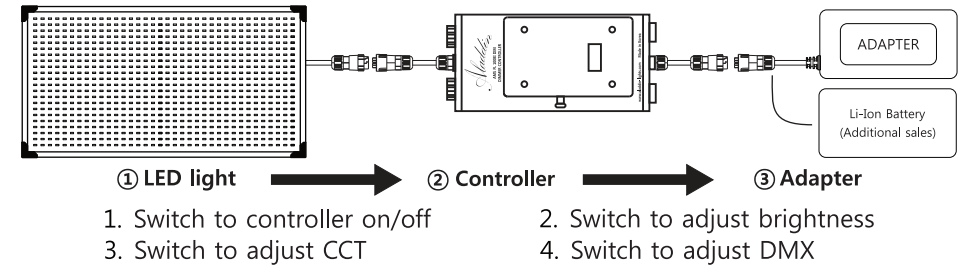

Controllers guide

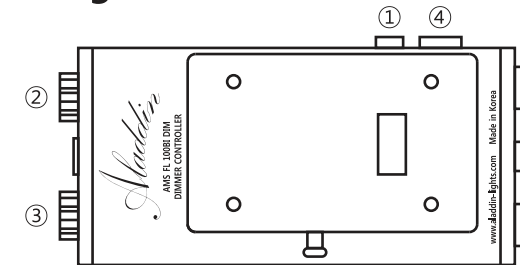

COMPOSITION

